

Date Printed: 06/16/2009

JTS Box Number: IFES_80
Tab Number: 113
Document Title: Official Sample Ballot
Document Date: Nov-90
Document Country: United States -- Florida
Document Language: English
IFES ID: CE02136

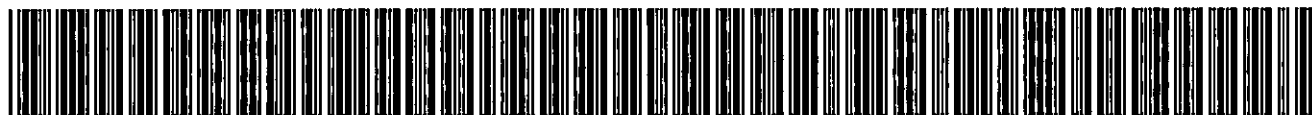

* 7 8 2 5 8 A 5 8 - B 6 9 D - 4 7 2 5 - 9 8 D 3 - B E 4 B 7 E 6 5 F E E *

Official

SAMPLE BALLOT



*It's
Vote*

*... a basic
American
Freedom*

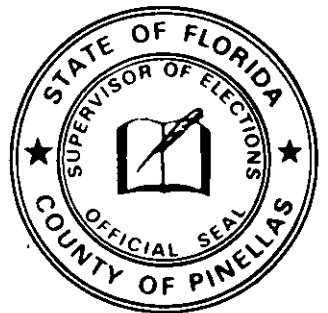

PINELLAS COUNTY, FLORIDA
NOVEMBER 6, 1990

IMPORTANT VOTING INFORMATION

You must vote in the precinct where you legally reside. If you cannot get to your polling place or if you are going to be out of the county on election day, either come into one of our Election Offices and vote absentee, or call **462-4590 NOW** to have an absentee ballot sent to you.

Remind your family and friends to vote. This sample ballot may be taken to the polls for reference.

Budget restrictions prevent us from mailing more than one sample ballot to each household regardless of how many voters reside there. Additional copies may be picked up at any of our offices as long as the supply lasts.

The Supervisor of Elections Offices are located at:

The Pinellas County Courthouse
315 Court Street, Room 117
Clearwater, Florida 34616-5190
462-3551

The Election Service Center
Building 2, Suite A
14255 49th Street N.
Clearwater, Florida 34622
530-6110

The County Building
150 5th Street N., Room 103
St. Petersburg, Florida 33701
892-7851



The polls are staffed for November 6, 1990, but we are always planning ahead for the next election.

Over 2,000 pollworkers are used in the 316 precincts in Pinellas County on Election Day. Efficiency, patience, friendliness and dedication are needed to serve in this capacity.

If you are interested in working at the polls, please come to one of our offices for an interview.

Sincerely,

Dorothy Walker Ruggles
Supervisor of Elections



100% Recycled paper, naturally!

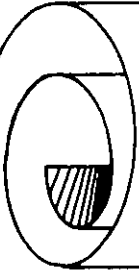

PINELLAS CITIZEN

October 1990

Dear Voter,

It is my hope that this Sample Ballot will help you "get a head-start" on voting November 6. As you know, all elections are important and because YOUR VOTE does make a difference, we are sending each voting household a sample ballot.

This is only a sample of the total ballot for Pinellas County! It is not possible at this time to send you the ballot representing your voting district only. Please study the issues and candidates, select the ones that represent you, and VOTE November 6.

Pinellas County is divided into 316 precincts and has 20 different ballot styles representing the U.S. Congress, State Senate and House of Representatives, School Board, and the Board of County Commissioners. There are also 24 municipalities within Pinellas County.

Your precinct number and district numbers are designated on your Voter Identification Card. If you have lost your ID card, write and request a new one. However, if you are eligible to vote and you do not have your voter ID card, you may take other identification (a driver's license, for example) to your polling place on election day.

If you have any questions regarding the election process, call 462-3551. Thank you for your interest, and please vote!

Sincerely,

Dorothy Walker Ruggles
Supervisor of Elections

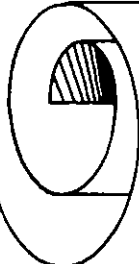

SUPERVISOR OF ELECTIONS

POLLING PLACES

- 101 Carlton Arms Apartments 6699 31 Way S. SP
- 102 Suncoast Manor 6909 9 St. S. SP
- 103 Bay Vista Adult Center 7000 4 St. S. SP
- 104 Bay Vista Elementary School 5900 9 St. S. SP
- 105 Lake Vista Community Center 1401 62 Ave. S. SP
- 106 Maximo Presbyterian Church 3200 58 Ave. S. SP
- 107 Maximo Elementary School 4850 31 St. S. SP
- *108 South Branch Library 1201 Country Club Way S.SP
- *109 Covenant Presbyterian Church 4201 6 St. S. SP
- 110 Coquina Key Property Owners Association 3850 Pompano Dr. SE SP
- 111 Wilders Mobile Homeowners Association 770 32 Ave. S. SP
- *112 St. Petersburg Little Theatre—Lobby 4025 31 St. S. SP
- 113 St. Petersburg Challenge School 2350 22 Ave. S. SP
- 114 New Hope Baptist Church 2120 19 St. S. SP
- 115 Lakeview Presbyterian Church 1310 22 Ave. S. SP
- 116 Frank W. Pierce Community Center Double w/*119)
2000 7 St. S. SP
- *117 St. Pete Religious Society of Friends (Double w/118)
130 19 Ave. SE SP
- 118 St. Pete Religious Society of Friends (Double w/*117)
130 19 Ave. SE SP
- *119 Frank W. Pierce Community Center (Double w/116)
2000 7 St. S. SP
- 126 St. Mary Our Lady of Grace Church 515 4 St. S. SP
- 127 Campbell Park Neighborhood Center 601 14 St. S. SP
- 128 Bethel Community Baptist Church 1045 16 St. S. SP
- 129 Wildwood Community Center 2650 10 Ave. S. SP
- 130 First Baptist Institutional Church 3144 3 Ave. S. SP
- 131 Graham Park Apartments—Auditorium 305 9 St. S. SP
- 132 Columbian Apartments 518 3 Ave. S. SP
- 133 Carlton Towers 470 3 St. S. SP
- 134 Presbyterian Towers, Inc.— Community Room 430 Bay St. NE SP
- 135 Peterborough Apartments 440 4 Ave. N. SP
- 136 Dwight H. Jones Neighborhood Center 1035 Burlington Ave. N. SP
- 137 SPIFFS (Double w/*138) 2201 1 Ave. N. SP
- *138 SPIFFS (Double w/137) 2201 1 Ave. N. SP
- *139 Woodlawn Complex (Triple w/143/*144) 1450 16 St. N. SP
- 140 American Legion Post #14 (Double w/*142) 1520 4 St. N. SP
- 141 First Presbyterian Church 701 Beach Dr. NE SP
- *142 American Legion Post #14 (Double w/140) 1520 4 St. N. SP
- 143 Woodlawn Complex (Triple w/*139/*144) 1450 16 St. N. SP
- *144 Woodlawn Complex (Triple w/*139/143) 1450 16 St. N. SP
- *145 30th Avenue Baptist Church 3241 30 Ave. N. SP
- 146 St. Bede's Episcopal Church 2500 16 St. N. SP
- 147 Woodlawn Presbyterian Church 2612 12 St. N. SP
- 148 American Baptist Church of the Beatitudes 2812 8 St. N. SP
- 155 St. Raphael's Catholic Church— (Church Hall)
1376 Snell Isle Blvd. NE SP
- 156 Shore Acres Recreation Center (Double w/*159)
4230 Shore Acres Blvd. NE SP
- 157 Lutheran Church of the Cross (Double w/*158)
4545 Chancellor St. NE SP
- *158 Lutheran Church of the Cross (Double w/157)
4545 Chancellor St. NE SP
- *159 Shore Acres Recreation Center (Double w/156)
4230 Shore Acres Blvd. NE SP
- *160 Northeast Presbyterian Church 4400 Shore Acres Blvd. NE SP
- *161 Masonic Home of Florida (Double w/162) 3201 1 St. NE SP
- 162 Masonic Home of Florida (Double w/*161) 3201 1 St. NE SP
- 163 First Church of God 2813 30 Ave. N. SP
- *164 St. Petersburg L.O.O.M. 1145 (Double w/173) 2525 58 Ave. N. SP
- 165 Northside United Methodist Church 4344 21 St. N. SP
- 166 Roberts Community Center (Double w/*171) 1246 50 Ave. N. SP
- 167 First Unity Church (Double w/*168) 469 45 Ave. N. SP
- *168 First Unity Church (Double w/167) 469 45 Ave. N. SP
- 169 Faith Covenant Church (Double w/*170) 150 62 Ave. NE SP
- *170 Faith Covenant Church (Double w/169) 150 62 Ave. NE SP
- *171 Roberts Community Center (Double w/166) 1246 50 Ave. N. SP
- 172 Town Apartments—North 1900 61 Ave. N. SP
- 173 St. Petersburg L.O.O.M. 1145 (Double w/*164)
2525 58 Ave. N. SP
- *174 Bethel Evangelical Lutheran Church (Double w/180)
1801 62 Ave. N. SP
- 180 Bethel Evangelical Lutheran Church (Double w/*174)
1801 62 Ave. N. SP
- *181 Willis S. Johns Neighborhood Center (Double w/182)
6635 9 St. N. SP
- 182 Willis S. Johns Neighborhood Center (Double w/*181)
6635 9 St. N. SP
- 183 Mobil Americana, Inc. 7201 1 St. NE SP
- *184 Shore Acres Elementary School 1800 62 Ave. NE SP
- 185 Gateway Mall—Northwest Entrance (Double w/*186)(New)
7885 9 St. N. SP
- *186 Gateway Mall—Southwest Entrance (Double w/185)
7885 9 St. N. SP
- 187 Epiphany Ukrainian Catholic Church 434 90 Ave. N. SP
- 188 Pinewood Mobile Village—Recreation Center 10441 Gandy Blvd. SP
- 189 The Meadows Apartments 785 117 Terr. N. SP
- 190 Bel-Air Apartments 1200 102 Ave. N. SP
- 191 Sunset Mobile Home Park 3401 Gandy Blvd. PP
- 192 Mainlands—Unit #2 4320 Mainlands Blvd. PP
- 193 The Lakes Homeowners Association 4591 Lakes Blvd. CW
- 201 A. Clinton Brooks & Company, Inc. 5901 Sun Blvd., Suite 105 SP
- *202 St. Bartholomew's Episcopal Church 3747 34 St. S. SP
- 203 Bethel Metropolitan Baptist Church (Double w/*205)
3455 26 Ave. S. SP
- *204 Prayer Tower Church of God In Christ (Double w/225)
1100 37 St. S. SP
- *205 Bethel Metropolitan Baptist Church (Double w/203)
3455 26 Ave. S. SP
- 206 Gulfport Presbyterian Church 5313 27 Ave. S. GP
- 208 Gulfport Community Center 5730 Shore Blvd. S. GP
- 209 Sunshine Lodge (New) 2109 51 St. S. GP
- 210 Gulfport Church of Nazarene 1000 55 St. S. GP
- 211 Most Holy Name of Jesus Church 5800 15 Ave. S. GP
- *212 Pasadena Baptist Church 635 64 St. S. SP
- 213 Bethany Towers—Recreation Hall 880 Oeander Way S. SA
- 214 South Pasadena Municipal Building 7047 Sunset Dr. S. SA
- *215 Pasadena Presbyterian Church (Double w/232)
100 Pasadena Ave. N. SP
- 220 Anchor Building 6830 Central Ave., Suite C SP
- 221 Temple Beth El 400 Pasadena Ave. S. SP
- 222 Our Savior Lutheran Church (Double w/*223) 301 58 St. S. SP
- *223 Our Savior Lutheran Church (Double w/222) 301 58 St. S. SP
- 224 Childs Park Community Center 4301 13 Ave. S. SP
- 225 Prayer Tower Church of God In Christ (Double w/*204)
1100 37 St. S. SP
- 226 Galilee Missionary Baptist Church 505 35 St. S. SP
- 227 Mt. Pilgrim Church 4051 5 Ave. S. SP
- 228 Calvary Foursquare Church 3900 5 Ave. N. SP
- 229 St. Luke's United Methodist Church (Double w/*238)
4444 5 Ave. N. SP
- *230 Emmanuel Baptist Church 4901 5 Ave. N. SP
- 231 Pilgrim Congregational Church 6315 Central Ave. SP
- 232 Pasadena Presbyterian Church (Double w/*215)
100 Pasadena Ave. N. SP
- 233 Azalea Adult Center 1600 72 St. N. SP
- 234 Brandywine Apartments—Recreation Hall 1699 68 St. N. SP
- 235 Notre Dame Building 6533 9 Ave. N. SP
- *236 Garden Crest Presbyterian Church (New) 5901 9 Ave. N. SP
- 237 Casa De Seville 5701 6 Ave. N. SP
- *238 St. Luke's United Methodist Church (Double w/229)
4444 5 Ave. N. SP



100% Recycled paper, naturally!

* Indicates Outside Precinct Boundaries
(New) Indicates a change from 1989 Tax Referendum Election

POLLING PLACES (cont'd)

- 239 Salvation Army 3800 9 Ave. N. SP
 *240 St. Therese Catholic Church (Double w/241) 4265 13 Ave. N. SP
 241 St. Therese Catholic Church (Double w/**240) 4265 13 Ave. N. SP
 *242 Trinity United Church of Christ 1150 49 St. N. SP
 243 Garden of Peace Lutheran Church (Double w/**250) (New)
 6161 22 Ave. N. SP
 244 Palm Lake Christian Church 5401 22 Ave. N. SP
 245 Community Covenant Church 4501 30 Ave. N. SP
 *246 Christ Lutheran Church (Double w/247) 3451 30 Ave. N. SP
 247 Christ Lutheran Church (Double w/**246) 3451 30 Ave. N. SP
 248 Clearview United Methodist Church 4515 38 Ave. N. SP
 *249 First Free Methodist Church 5200 29 Ave. N. SP
 *250 Garden of Peace Lutheran Church (Double w/243) (New)
 6161 22 Ave. N. SP
 251 St. Stefanos Greek Orthodox Church 3600 76 St. N. SP
 252 Walter P. Fuller Park 7891 26 Ave. N. SP
 *253 First Florida Bank 3994 Tyrone Blvd. SP
 260 Portuguese American Suncoast Association, Inc. (New)
 7808 46 Ave. N. SP
 261 Clearview Oaks—Martha Ward Pavilion 5700 40 Ave. N. KC
 *262 Kenneth City Community Hall (Double w/264) 4600 58 St. N. KC
 263 D.A.V. Sunshine City Chapter 9 4801 37 St. N. SP
 264 Kenneth City Community Hall (Double w/**262) 4600 58 St. N. KC
 265 Pine Bay Community Club—Recreation Hall 5330 77 St. N. SP
 *266 Liberty Temple Church 8642 Starkey Rd. SE
 267 Five Towns Condominiums—Recreation Hall 8141 54 Ave. N. SP
 268 Bonnie Bay—Clubroom 7400 62 Terr. N. PP
 269 First Missionary Church (New) 5475 54 Ave. N. SP
 270 Heatherwood Project—Recreation Hall 3800 62 Ave. N. PP
 271 Pinellas Park Wesleyan Church 4400 70 Ave. N. PP
 *272 McKee Lake Alliance Church 5972 62 Ave. N. PP
 273 German-American Club (Double w/**283) (New) 8098 66 St. N. PP
 *274 Bardmoor Community Center (Double w/276)
 8345 Bardmoor Blvd. LA
 275 Osceola Middle School 9301 98 St. N. SE
 276 Bardmoor Community Center (Double w/**274)
 8345 Bardmoor Blvd. LA
 277 Pinellas Park City Auditorium 7680 59 St. N. PP
 278 Plumbers & Pipefitters Local Union 111 4020 80 Ave. N. PP
 279 Skyview Recreation Hall (Double w/**280) 9010 54 Way N. PP
 *280 Skyview Recreation Hall (Double w/279) (New) 9010 54 Way N. PP
 281 Grace Bible Fellowship—Fellowship Hall 10999 60 St. N. PP
 282 Minnreg Building 6340 126 Ave. N. LA
 *283 German-American Club (Double w/273) (New) 8098 66 St. N. PP
 290 Enterprise Village (New) 12100 Starkey Rd. LA
 *291 Rancho Village Mobile Home Park (Triple w/**292/293)
 7211 Ulmerton Rd. LA
 *292 Rancho Village Mobile Home Park (Triple w/**291/293)
 7211 Ulmerton Rd. LA
 293 Rancho Village Mobile Home Park (Triple w/**291/**292)
 7211 Ulmerton Rd. LA
 *301 Madeira Beach Middle School 591 Tom Stuart Causeway MB
 302 Bay Pines Mobile Home Park—Recreation Hall
 10005 Bay Pines Blvd. SP
 303 Harbor Lights Mobile Home Club—Recreation Hall
 9191 Bay Pines Blvd. SP
 *304 Seminole United Methodist Church (Double w/**305)
 5400 Seminole Blvd. SE
 *305 Seminole United Methodist Church (Double w/**304)
 5400 Seminole Blvd. SE
 306 Seminole City Hall (Double w/**308) 7464 Ridge Rd. SE
 307 Bay Ridge Baptist Church 6155 113 St. N. SE
 *308 Seminole City Hall (Double w/306) 7464 Ridge Rd. SE
 309 Chapel on the Hill 12601 Park Blvd. SE
 310 Lake Seminole Presbyterian Church 11250 86 Ave. N. SE
 *316 Lutheran Church of the Good Shepherd (Double w/325)
 10891 102 Ave. N. SE
 317 Community Bible Church of Seminole 9100 113 St. N. SE
 318 Bauder Elementary School 12755 86 Ave. N. SE
 319 Indian Rocks Fire District #2 13501 94 Ave. N. LA
 320 Tamarac-By-The-Gulf, Inc. (Double w/**321) (New)
 9099 141 St. N. SE
 *321 Tamarac-By-The-Gulf, Inc. (Double w/320) (New)
 9099 141 St. N. SE
 322 Christ the King Lutheran Church (Double/**343)
 11220 Oakhurst Rd. LA
 323 Seminole Christian Church 10202 131 St. N. SE
 *324 St. Dunstan's Episcopal Church (Double w/329)
 10888 126 Ave. N. LA
 325 Lutheran Church of the Good Shepherd (Double w/**316)
 10891 102 Ave. N. SE
 326 Holiday Shores Park, Inc. (New) 10398 104 Ave. N. SE
 327 Orange Lake Civic Center 11803 104 St. N. LA
 328 Pointe West Mobile Home Park—Clubhouse
 12651 Seminole Blvd. LA
 329 St. Dunstan's Episcopal Church (Double w/**324)
 10888 126 Ave. N. LA
 330 Pinellas County Cooperative Extension Service 12175 125 St. N. LA
 *342 Southwest Recreation Complex (Triple w/**344/**357)
 13120 Vonn Rd. LA
 *343 Christ the King Lutheran Church (Double w/322) 11220 Oakhurst
 Rd. LA
 *344 Southwest Recreation Complex (Triple w/**342/**357)
 13120 Vonn Rd. LA
 345 Omni Center 1801 119 St. N. LA
 346 Palm Hill Country Club—South—Recreation Hall
 1800 Seminole Blvd. LA
 347 Oak Crest Mobile Home Park 1001 Ulmerton Rd. LA
 349 Fairway Village Mobile Home Park 1100 Belcher Rd. S. LA
 350 Bay Ranch Mobile Village 7200 Ulmerton Rd. LA
 351 Ranch Mobile Co-Op 6800 150 Ave. N. CW
 352 East Bay Oaks Mobile Home Park—Recreation Hall
 601 Starkey Rd. LA
 353 Magnolia Square Condominium (New) 501 East Bay Dr. LA
 354 Largo Senior Center 151 3 St. NW LA
 355 Christ Presbyterian Church (Double w/**356) 3115 Dryer Ave. LA
 *356 Christ Presbyterian Church (Double w/355) 3115 Dryer Ave. LA
 *357 Southwest Recreation Complex (Triple w/**342/**344)
 13120 Vonn Rd. LA
 358 Belleair Bluffs City Hall 115 Florence Dr. BL
 359 Largo Wesleyan Church 1301 8 Ave. NW LA
 *360 First Assembly of God Church (Triple w/**369/**370)
 1739 Greenwood Ave. S. CW
 361 Masonic Star Lodge #78 1145 Highland Ave. N. LA
 362 Largo Recreation—Highland Complex 400 Highland Ave. N. LA
 *363 Elks Lodge #2159 3075 East Bay Dr. LA
 364 St. Catherine of Siena Catholic Church 1955 Belcher Rd. S. CW
 *365 St. John's Episcopal Church 1676 Belcher Rd. S. CW
 366 Hope Presbyterian Church 1698 Belcher Rd. S. CW
 367 Highland United Presbyterian Church of Largo
 1885 Highland Ave. S. CW
 *368 Community Reformed Church (Double w/502) 1430 Belleair Rd. CW
 *369 First Assembly of God Church (Triple w/**360/**370)
 1739 Greenwood Ave. S. CW
 *370 First Assembly of God Church (Triple w/**360/**369)
 1739 Greenwood Ave. S. CW
 *371 Belleair Civic Building (Double w/372) 901 Ponce De Leon Blvd. BE
 372 Belleair Civic Building (Double w/**371) 901 Ponce De Leon Blvd. BE
 401 A. Clinton Brooks & Company, Inc. 1110 Pinellas Bayway #111 TV
 402 Warren Webster Community Center 15 Ave. & Pass-a-Grille Way SB
 403 Don Vista Community Center 3300 Gulf Blvd. SB



POLLING PLACES (cont'd)

- *404 St. Petersburg Beach Municipal Building (Double w/405)
7701 Boca Ciega Dr. SB
- 405 St. Petersburg Beach Municipal Building (Double w/*404)
7701 Boca Ciega Dr. SB
- 408 Treasure Island Community Center One Park Place TI
- 415 Madeira Beach Municipal Building—Assembly Room
300 Municipal Dr. MB
- 416 Redington Beach Fire Station 101 164 Ave. RB
- 417 North Redington Beach Town Hall 190 173 Ave. NB
- 418 Redington Shores Town Hall 17798 Gulf Blvd. RS
- 419 Indian Shores Town Hall 19305 Gulf Blvd. IS
- 420 Indian Rocks Beach City Hall 1507 Bay Palm Blvd. IR
- *421 Belleair Beach City Hall (Double w/422) 444 Causeway Blvd. BB
- 422 Belleair Beach City Hall (Double w/*421) 444 Causeway Blvd. BB
- 501 Ross Norton Recreation Center 1426 Greenwood Ave. S. CW
- 502 Community Reformed Church (Double w/*368)
1430 Belleair Rd. CW
- 503 First Evangelical Lutheran Church (Double w/*504)
1644 Nursery Rd. CW
- *504 First Evangelical Lutheran Church (Double w/503)
1644 Nursery Rd. CW
- *505 Morningside Recreation Complex (Double w/506)
2400 Harn Blvd. CW
- 506 Morningside Recreation Complex (Double w/*505)
2400 Harn Blvd. CW
- 507 Clearwater Masonic Lodge 127 F & AM 705 S. Hercules CW
- 508 Central Christian Church of Clearwater 1200 Keene Rd. CW
- 509 Clearwater Fire Station #3 1460 Lakeview Rd. CW
- 510 St. Cecilia Catholic Church (Double w/*511)(New)
820 Jasmine Way CW
- *511 St. Cecilia Catholic Church (Double w/510)(New)
820 Jasmine Way CW
- 512 Clearwater Public Library 100 Osceola Ave. N. CW
- 513 Greater Clearwater Board of Realtors (Double w/*514)
1330 Cleveland St. CW
- *514 Greater Clearwater Board of Realtors (Double w/513)
1330 Cleveland St. CW
- *515 East Branch Library (Double w/516) 2251 Drew St. CW
- 516 East Branch Library (Double w/*515) 2251 Drew St. CW
- 517 York Rite Masonic Temple (Double w/*518) 407 Belcher Rd. N. CW
- *518 York Rite Masonic Temple (Double w/517) 407 Belcher Rd. N. CW
- 519 Fred Cournoyer Recreation Center 714 Saturn Ave. N. CW
- 520 Salvation Army 400 N. Fort Harrison Ave. CW
- 521 Sheraton Sand Key Resort 1160 Gulf Blvd. CB
- 522 Memorial Civic Center (Double w/*523) 40 Causeway Blvd. CB
- *523 Memorial Civic Center (Double w/522) 40 Causeway Blvd. CB
- 526 Martin Luther King Recreation Center
1201 Martin Luther King Ave CW
- 527 Clearwater Lawn Bowling 1040 Calumet St. CW
- 528 Kings Highway Recreation Center (Double w/*529)
1751 Kings Highway Rd. CW
- *529 Kings Highway Recreation Center (Double w/528)
1751 Kings Highway Rd. CW
- 530 VFW—Post 2473 1401 Hercules Ave. N. CW
- 531 Salvation Army (New) 1625 Belcher Rd. N. CW
- *532 Clearwater Elks Lodge 2750 Sunset Point Rd. CW
- 533 Top of the World—East Rec. Bldg. (Double w/*534)
2410 Sunset Point Rd. CW
- *534 Top of the World—East Rec. Bldg. (Double w/533)
2410 Sunset Point Rd. CW
- 535 Countryside Evangelical Covenant Church 2289 Hercules Ave. N. CW
- 536 Top of the World—West Rec. Bldg.
2290 World Parkway Blvd. W. CW
- 537 Hercules Community Church of God 2110 Hercules Ave. N. CW
- 538 Faith Presbyterian Church 5 Patricia Ave. DU
- 539 VFW Post #2550 360 Douglas Ave. DU
- 540 First Presbyterian Church 644 Highland Ave. DU
- *545 Faith Lutheran Church (Double w/*549) 1620 Pinehurst Rd. DU
- 546 Mease Manor 700 Mease Plaza DU
- *547 City of Dunedin—Stirling Recreation Center 550 Laura Lane DU
- 548 Palm Lake Village—Recreation Hall 1515 County Road One DU
- *549 Faith Lutheran Church (Double w/*545) 1620 Pinehurst Rd. DU
- 550 St. Andrew's Presbyterian Church 705 Michigan Blvd. DU
- 551 Royal Stewart Arms—Recreation Hall 3 Gateshead Dr. DU
- 552 Kirk of Dunedin (Double w/*561) 2686 U.S. Alt. 19 N. DU
- *553 Dunedin Community Center 1141 Michigan Blvd. DU
- *554 North Dunedin Baptist Church 1595 Michigan Blvd. DU
- 555 North County Services Building 29582 U.S. Hwy. 19 N. CW
- 560 Temple Ahavat Shalom 1575 Curlew Rd. PH
- *561 Kirk of Dunedin (Double w/552) 2686 U.S. Alt. 19 N. DU
- 562 First Baptist Church Ozone—Palm Harbor 610 Pennsylvania Ave. OZ
- 563 Crystal Beach Civic Center 517 Crystal Beach Ave. CR
- 564 Lutheran Church of the Palms 2250 Nebraska Ave. PH
- 565 Palm Harbor Library 2330 Nebraska Ave. PH
- *566 Palm Harbor Fire Station #2 (Double w/567) 2300 Glen Eagle
Parkway PH
- 567 Palm Harbor Fire Station #2 (Double w/*566) 2300 Glen Eagle
Parkway PH
- 568 Baywood Village 309 Westwind Dr. PH
- 601 Election Service Center 14255 49 St. N. Bldg. 2 CW
- 602 Feather Sound Community Church 13880 Feather Sound Dr. CW
- 603 Abilities Rehabilitation Center Inc. of Florida 2735 Whitney Rd. CW
- 604 Cove Cay—Village Four Recreation Hall 3500 Cove Cay Dr. CW
- 605 Bay Aristocrat 18675 U.S. Hwy. 19 N. CW
- 606 Bethel Presbyterian Church—Fellowship Hall 2905 Gulf to Bay
Blvd. CW
- 607 Eisenhower Elementary School 2800 Drew St. CW
- 608 Calvary Open Bible Church 11 McMullen Booth Rd. CW
- 609 Wood Valley Recreation Center 2816 Park Trail Lane CW
- 610 Paul B. Stephens, Jr. Exceptional Center—Hallway 2929 County
Road 193 CW
- 611 Heritage United Methodist Church—Youth Lounge 2680 Landmark
Drive CW
- 612 Bethel Lutheran Church—Social Hall 3166 McMullen Booth Rd. CW
- *613 Northwood Presbyterian Church 2875 State Road 580 CW
- 614 Palm Harbor Fire Station #65 250 West Lake Rd. PH
- 615 Coral Oaks Retirement Community (New) 2650 West Lake Rd. PH
- 616 Highland Lakes Club 3300 MacGregor Dr. PH
- 617 St. Lukes Catholic Church 2757 Alderman Rd. PH
- 618 All Saints Catholic Church (New) 2801 Culew Rd. CW
- 619 Cypress Point Campgrounds 37969 U.S. Hwy. 19 N. PH
- 620 Safety Harbor City Hall—Auditorium 750 Main Street SH
- 621 Espiritu Santo Catholic Church 2405 Phillippe Parkway SH
- 622 California Federal (Northwood Oaks) 2519 McMullen Booth Road CW
- 623 Safety Harbor Fire Station #2 3095 McMullen Booth Rd. SH
- *629 Community United Methodist (Double w/630) 207 East Buckingham
Ave. OM
- 630 Community United Methodist (Double w/*629) 207 East
Buckingham Ave. OM
- 631 Gull Aire Village—Clubhouse 3000 Curlew Rd. OM
- 632 Cypress Woods Elementary School 4900 Cypress Woods Blvd. PH
- 633 Lutheran Church of the Resurrection 1555 Windmill Pointe Rd. PH
- *701 First Baptist Church (Double w/705) 1021 Gulf Rd. TS
- 702 Tarpon Springs Manor (Off Lake Street) 610 South Mayo Dr. TS
- 703 All Saints Episcopal Church—Parish Hall 1700 Keystone Rd. TS
- 704 Union Academy Cultural Center (Lake & Grosse) 401 E. Lake St. TS
- 705 First Baptist Church (Double w/*701) 1021 Gulf Rd. TS
- 706 Craig Park Recreation Center (Double w/*709) 312 South Spring
Blvd. TS
- 707 St. Ignatius Catholic Church 725 Orange St. E. TS
- *709 Craig Park Recreation Center (Double w/706) 312 South Spring
Blvd. TS
- *710 First Christian Church of Tarpon Springs 2795 Keystone Rd. TS



General Voting Instructions to be used at the polling place

Step 1 Using both hands, insert the ballot card all the way into the Votomatic.

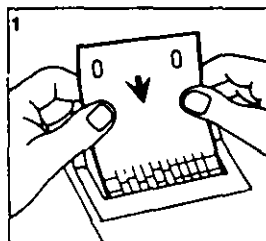

Step 2 Be sure the two slots in the end of your card fit down over the two red pins.

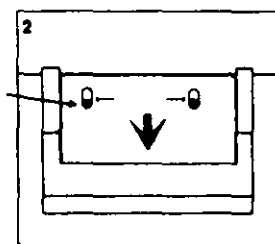

Step 3 To vote, hold the voting instrument straight up. Punch straight down through the ballot card for the candidates of your choice. Do not use pen or pencil.

Step 4 Vote all pages.

Step 5 After voting, remove the ballot card from the Votomatic.

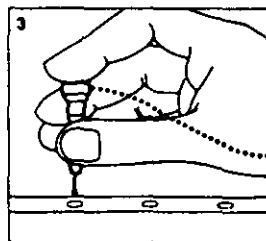

Note If you make a mistake, return your ballot card and obtain another.

**PUNCH OUT BALLOT CARD ONLY WITH
PUNCHING DEVICE PROVIDED, NEVER
WITH PEN OR PENCIL**

VOTE ALL PAGES

Write-In Voting Instructions

To vote for a person NOT on the ballot, write in BOTH the title of the office and the candidate's name on the lines printed on the long stub of the ballot card.



100% Recycled paper. Naturally!

**OFFICIAL BALLOT
GENERAL ELECTION
PINELLAS COUNTY, FLORIDA
November 6, 1990**

CONGRESSIONAL

**REPRESENTATIVE
IN CONGRESS
9th
CONGRESSIONAL
DISTRICT
—Vote for ONE—**

MICHAEL BILIRAKIS (REP.) 5 →

CHERYL DAVIS KNAPP (DEM.) 6 →

STATE

**GOVERNOR
AND
LT. GOVERNOR**

BOB MARTINEZ
For Governor } (REP.) 9 →
ALLISON DEFOOR
For Lt. Governor }

**—Vote for
ONE GROUP—**

LAWTON CHILES
For Governor } (DEM.) 11 →
BUDDY WACKAY
For Lt. Governor }

To Vote for a Write-In Candidate for Governor and Lt. Governor,
follow the directions on the long stub of the ballot card.

**SECRETARY
OF STATE
—Vote for ONE—**

JIM SMITH (REP.) 15 →

JIM MINTER (DEM.) 16 →

To Vote for a Write-In Candidate for Secretary of State,
follow the directions on the long stub of the ballot card.

**COMPTROLLER
—Vote for ONE—**

CHRIS COMSTOCK (REP.) 21 →

GERALD LEWIS (DEM.) 22 →

**TREASURER
—Vote for ONE—**

TOM GALLAGHER (REP.) 25 →

GEORGE STUART (DEM.) 26 →

**COMMISSIONER
OF
EDUCATION
—Vote for ONE—**

CLAUDE R. KIRK (REP.) 29 →

BETTY CASTOR (DEM.) 30 →

To Vote for a Write-In Candidate for Commissioner of Education,
follow the directions on the long stub of the ballot card.



**OFFICIAL BALLOT
GENERAL ELECTION
PINELLAS COUNTY, FLORIDA
November 6, 1990**

STATE			
COMMISSIONER OF AGRICULTURE —Vote for ONE—	CHARLES BRONSON	(REP.)	34 →
	BOB CRAWFORD	(DEM.)	35 →
	To Vote for a Write-In Candidate for Commissioner of Agriculture, follow the directions on the long stub of the ballot card.		
STATE SENATOR 18th SENATORIAL DISTRICT —Vote for ONE—	DON SULLIVAN	(REP.)	41 →
	JEANNE MALCHON	(DEM.)	42 →
STATE REPRESENTATIVE 51st HOUSE DISTRICT —Vote for ONE—	PATRICIA A. "TRISH" MUSCARELLA	(REP.)	43 →
	MARILYN J. DEWEY	(DEM.)	44 →
STATE REPRESENTATIVE 54th HOUSE DISTRICT —Vote for ONE—	DOROTHY EATON SAMPLE	(REP.)	45 →
	LARS A. HAFNER	(DEM.)	46 →
STATE REPRESENTATIVE 57th HOUSE DISTRICT —Vote for ONE—	JAMES C. 'JIM' FRISHE	(REP.)	47 →
	MARY BRENNAN	(DEM.)	48 →
COUNTY			
SCHOOL BOARD MEMBER DISTRICT 2 —Vote for ONE—	BRUCE H. MCDOWELL	(REP.)	50 →
	LINDA LERNER	(DEM.)	51 →
SCHOOL BOARD MEMBER AT-LARGE —Vote for ONE—	FRANK X. PESUTH	(REP.)	54 →
	JOHN SANGUINETT	(DEM.)	55 →



**OFFICIAL BALLOT
GENERAL ELECTION—NONPARTISAN JUDICIAL
PINELLAS COUNTY, FLORIDA
November 6, 1990**

JUSTICE OF THE SUPREME COURT		
Shall Justice LEANDER J. SHAW, JR. of the Supreme Court be retained in office?	YES	61 →
	NO	62 →
DISTRICT COURT OF APPEAL		
Shall Judge CHRIS W. ALTENBERND of the Second District Court of Appeal be retained in office?	YES	65 →
	NO	66 →
Shall Judge PAUL W. DANAHY, JR. of the Second District Court of Appeal be retained in office?	YES	69 →
	NO	70 →
Shall Judge JAMES E. LEHAN of the Second District Court of Appeal be retained in office?	YES	73 →
	NO	74 →
Shall Judge JERRY R. PARKER of the Second District Court of Appeal be retained in office?	YES	78 →
	NO	79 →
Shall Judge DAVID F. PATTERSON of the Second District Court of Appeal be retained in office?	YES	82 →
	NO	83 →
Shall Judge HERBOTH S. RYDER of the Second District Court of Appeal be retained in office?	YES	86 →
	NO	87 →
CIRCUIT JUDGE SIXTH JUDICIAL CIRCUIT, GROUP 35 —Vote for ONE—	BRUCE BOYER	90 →
	CHARLES W. COPE	91 →



**OFFICIAL BALLOT—GENERAL ELECTION
PROPOSED AMENDMENTS TO THE CONSTITUTION
OF THE STATE OF FLORIDA
November 6, 1990**

**NO. 1 CONSTITUTIONAL AMENDMENT ARTICLE III, SECTION 3
REGULAR LEGISLATIVE SESSIONS**

Proposing an amendment to the State Constitution to require the Legislature to convene at an earlier specified date in 1991 and, in 1992 and thereafter, to convene on the first Tuesday after the first Monday in February of each odd-numbered year and on the first Tuesday after the first Monday in February, or such other date as may be fixed by law, of each even-numbered year.

YES for Approval 103 →

NO for Rejection 104 →

**NO. 2 CONSTITUTIONAL AMENDMENT ARTICLE I, SECTION 8
THREE-DAY WAITING PERIOD FOR HANDGUN PURCHASES**

Requires a mandatory period of three days, excluding weekends and legal holidays, between the purchase and delivery at retail of any handgun. Defines the terms "purchase" and "handgun" and requires the Legislature to enact legislation to provide a felony penalty for violations.

YES for Approval 112 →

NO for Rejection 113 →

**NO. 3 CONSTITUTIONAL AMENDMENT ARTICLE VII, SECTION 18
LAWS AFFECTING LOCAL GOVERNMENTAL EXPENDITURES
OR ABILITY TO RAISE REVENUE
OR RECEIVE STATE TAX REVENUE**

Excuses counties and municipalities from complying with general laws requiring them to spend funds unless: the law fulfills an important state interest; and it is enacted by two-thirds vote, or funding or funding sources are provided, or certain other conditions are met. Prohibits general laws that have certain negative fiscal consequences for counties and municipalities unless enacted by two-thirds vote. Exempts certain categories of laws from these requirements.

YES for Approval 123 →

NO for Rejection 124 →

**NO. 4 CONSTITUTIONAL AMENDMENT ARTICLE III, SECTION 4
OPEN GOVERNMENT**

Proposing an amendment to the State Constitution to provide that certain votes of legislators be recorded; that the Legislature provide by rule for open and noticed committee meetings and for certain other legislative meetings and meetings between the Governor, the President of the Senate, or the Speaker of the House to be reasonably open to the public; and that certain constitutional provisions relating to the Legislature be interpreted, implemented, and enforced solely by the Legislature.

YES for Approval 131 →

NO for Rejection 132 →

**OFFICIAL BALLOT—GENERAL ELECTION
PALM HARBOR SPECIAL FIRE CONTROL DISTRICT
PINELLAS COUNTY, FLORIDA—November 6, 1990**

**COMMISSIONER
SEAT 2
—Vote for ONE—**

JAY CAMPBELL, JR.

141 →

LEWIS U. GREEN, JR.

142 →

**COMMISSIONER
SEAT 4
—Vote for ONE—**

LEON A. DOYEN

145 →

IRENE RAUSCH

146 →

**OFFICIAL BALLOT—GENERAL ELECTION
EAST LAKE COMMUNITY SERVICES DISTRICT
PINELLAS COUNTY, FLORIDA—November 6, 1990**

**EAST LAKE COMMUNITY SERVICES DISTRICT
LIBRARY SERVICES—TAX LEVY**

1) Shall the Board of County Commissioners of Pinellas County, Florida, be authorized to levy up to one-quarter (.25) mill ad valorem taxes annually, pursuant to Pinellas County Ordinance No. 90-76, within the East Lake Community Services District for the purpose of funding a public library facility and related land acquisitions which shall be used for library and other related community services in place of the one-half (0.5) mill authorized previously for the purpose of providing free access to library services in existing facilities?

YES (For approval)

161 →

NO (For rejection)

162 →

**EAST LAKE COMMUNITY SERVICES DISTRICT
RECREATIONAL FACILITIES—TAX LEVY**

2) Shall the Board of County Commissioners of Pinellas County, Florida, be authorized to levy up to one-quarter (.25) mill ad valorem taxes annually, pursuant to Pinellas County Ordinance No. 90-76, within the East Lake Community Services District for the purpose of funding recreational facilities, services, programs, and related land acquisitions?

YES (For approval)

169 →

NO (For rejection)

170 →

**OFFICIAL REFERENDUM BALLOT
CITY OF BELLEAIR BLUFFS, FLORIDA
November 6, 1990**

**EXPENDITURE OF TAX FUNDS
FOR A COMMUNITY CENTER**

Do you approve of the City of Belleair Bluffs authorizing the use of general tax funds and one cent sales surtax funds to purchase property, construct in cooperation with private efforts if necessary, operate and maintain a community center for the general use of all citizens of Belleair Bluffs?

YES (for the use of tax funds) 176 →

NO (against the use of tax funds) 177 →

**OFFICIAL REFERENDUM BALLOT
CITY OF MADEIRA BEACH, FLORIDA
November 6, 1990**

**CHARTER CHANGE
CANDIDATE QUALIFICATIONS**

SHALL THE CHARTER, ARTICLE III, SECTION 3.2(a) OF THE CITY OF MADEIRA BEACH BE CHANGED TO ALLOW CANDIDATES FOR DISTRICT COMMISSIONER TO OBTAIN PETITION CARDS AT LARGE RATHER THAN SOLELY FROM THEIR DISTRICT AND TO REQUIRE THAT NO ELECTOR SIGN MORE THAN ONE (1) PETITION FOR ANY GIVEN SEAT?

YES for Approval 178 →

NO for Rejection 179 →

**OFFICIAL REFERENDUM BALLOT
CITY OF ST. PETERSBURG BEACH, FLORIDA
November 6, 1990**

COMMISSION COMPENSATION

SHALL SECTION 3.04 OF THE CHARTER OF THE CITY OF ST. PETERSBURG BEACH BE AMENDED TO PROVIDE THAT THE CITY COMMISSIONERS OF THE CITY SHALL RECEIVE THE SUM OF \$400 PER MONTH AND THE MAYOR-COMMISSIONER SHALL RECEIVE THE SUM OF \$600 PER MONTH AS COMPENSATION FOR THEIR SERVICES TO THE CITY DURING THE TIME THEY HOLD OFFICE?

YES (For) 180 →

NO (Against) 181 →

**OFFICIAL BALLOT
TOWN OF REDINGTON BEACH, FLORIDA
November 6, 1990**

MAYOR Two Year Term —Vote for ONE—	PETER FARNUM	194	→
	CHARLENE PALIN	195	→
COMMISSIONER Two Year Term —Vote for TWO—	ESTHER A. CLANCY	198	→
	NICHOLAS B. KORDAS	199	→
	ANN TERESE "TERRI" MADISON	200	→
	TRUDY NAKAMOTO	201	→
	JAMES (NICK) SIMONS JR.	202	→
	SCOTT WILSON	203	→

**OFFICIAL REFERENDUM BALLOT
TOWN OF REDINGTON BEACH, FLORIDA
November 6, 1990**

PROPOSAL TO AMEND THE CHARTER

Do you approve amending Part I. Sec. 5(b) of the Charter to provide for approval of a majority of electors voting in a referendum to establish monthly compensation for the Mayor of \$100.00 and monthly compensation for the Commissioners of \$50.00 with subsequent changes subject to approval by a majority of the electors voting in a referendum?

YES-For Approval 215 →

NO-For Rejection 216 →

PROPOSAL TO AMEND APPENDIX A, ZONING

Do you approve amending the Code of Ordinances of the Town of Redington Beach, as follows: Appendix A, Zoning, Section 3, Subsections 1A, 1B, 1C, 1D, 1E, 1F, 2A & 2B to establish the regulation of Home Occupations within the various zoning districts using the definition of Home Occupation as follows: A use conducted entirely within an enclosed dwelling, employing only the inhabitants thereof, which is clearly incidental and secondary to residential occupancy, which does not change the character thereof?

YES-For Approval 221 →

NO-For Rejection 222 →

**OFFICIAL REFERENDUM BALLOT
TOWN OF REDINGTON BEACH, FLORIDA
November 6, 1990**

PROPOSAL TO AMEND APPENDIX A, ZONING

Do you approve Ordinance No. 90-20 which amends Appendix A, Sec. 4 to set the same standards for construction materials in all districts of the town and allowing second story frame construction for single family residences when one hour fire rated exterior walls of type VI construction are used in such single family residences?

YES-For Approval 227 →

NO-For Rejection 228 →

**OFFICIAL REFERENDUM BALLOT
CITY OF OLDSMAR, FLORIDA
November 6, 1990**

**A CHARTER AMENDMENT REFERENDUM
PERTAINING TO CONSECUTIVE TERMS OF OFFICE
FOR MAYOR AND COUNCIL**

Do you favor Ordinance 90-18 allowing Mayor and Councilmembers to run for three (3) consecutive terms in office? (Two (2) consecutive terms are currently allowed by City Charter.)

YES 214 →

NO 215 →

**A CHARTER AMENDMENT REFERENDUM PERTAINING
TO TERM IN OFFICE FOR MAYOR AND COUNCIL**

Do you favor Ordinance 90-18 electing Mayor and Councilmembers for three (3) year terms in office? (Two (2) year terms in office are currently allowed by City Charter.)

YES 220 →

NO 221 →

**A CHARTER AMENDMENT REFERENDUM PERTAINING
TO HIRING AND REMOVING CHARTER OFFICIALS**

Do you favor Ordinance 90-18 hiring and firing Charter Officials (City Manager, City Clerk, City Attorney) by a three-fifths (3/5) vote of City Council? (Four-fifths (4/5) vote by City Council is presently required by City Charter.)

YES 226 →

NO 227 →

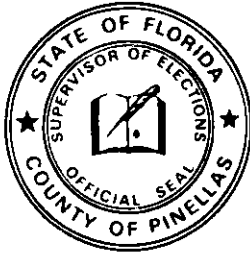

DOROTHY WALKER RUGGLES
Supervisor of Elections
Pinellas County Courthouse
315 Court Street - Room 117
Clearwater, Florida 34616-5190

Bulk Rate
U.S. Postage
PAID
Permit #3453
Tampa, FL

*****5-DIGIT 33701
TO ALL VOTERS AT
555 13 AVE NE
ST PETERSBURG FL 33701-1308

**ALL POLLING PLACES OPEN FROM 7 A.M. to 7 P.M.
PLEASE VOTE!**



100% Recycled paper, naturally!